

CHIP & SLUDGE CONVEYANCE EQUIPMENT

Model KSCL Magnetic Transfer Unit "TRANSFERLESS CONVEYOR" (CREEPER MAG)

MAGNETIC TOOLS & EQUIPMENT FOR MECHANICAL OPERATION

LIFTING MAGNET

MAGBORE* CHIP & SLUDGE CONVEYANCE EQUIPMENT

CHIP & SLUDGE CONVEYANCE EQUIPMENT

ENVIRONMENTAL EQUIPMENT

MAGNETIZER AND DEMAGNETIZER

MAGNETIC EQUIPMENT FOR CONVEYANCE

MAGNETIC SEPARATORS

POWERFUL MAGNETIC SEPARATORS

MEASURING TOOLS

MEASURING INSTRUMENTS

MAGNETIC MATERIALS

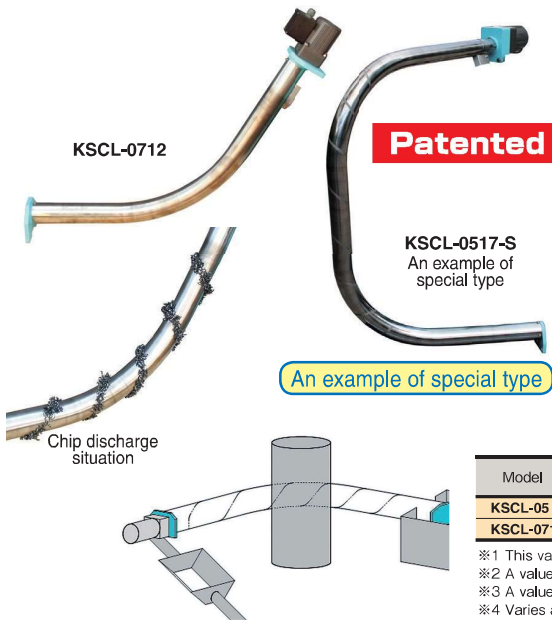

Flexible chip transfer! Lean layout to keep work environment neat! Shapes that fit installation space!

[Application]

This model is suitable for places where the linear type KSC is difficult to install.

[Features]

- The bending shape has been realized by a special construction to allow setting of the bending direction and angle according to installation conditions.
- This model can be installed in a very small space such as inside a machine.
- The layout where two linear type units are used to circumvent the existing facilities can be replaced by one unit.
- Special treatment of the pipe surface ensures reliable transfer. (Model KSCL-05)



Precaution for use

If you want to use the main unit immersed in liquid, please consult with us.

[mm(in)]

Model	Max. Length	Applicable Pipe Dia.	Min. Bending Radius	Max. No. of Bending Times	Processing Capacity	Power Source	Motor ※4	Mass
KSCL-05	Max. 4m	50 (1.96)	250 (9.84)	2 times ※1	18kg/h ※2	3-phase 200/220 VAC 50/60Hz	25W	12kg/26.4 lb
KSCL-0712	Max. 3m	76.3 (3.00)	500 (19.6)		25kg/h ※3		40W	25kg/55.1 lb

※1 This varies according to shapes. Please contact us in advance.
 ※2 A value obtained with SS400 chips using the KSCL-0517-S spec.
 ※3 A value obtained with SS400 chips using the KSCL-0712 spec.
 ※4 Varies according to specifications such as length.

Model MCO MAGNETIC CHIP CONVEYOR

[Application]

This model is designed to effectively attract, convey and remove chips produced from machine tools by a magnetic force while letting oil sticking to chips drop naturally. (This model is suitable for chips shorter than 60 mm.)

[Features]

- As chips are held by magnets, they can be conveyed on a sharp inclination. This feature enables it to shorten the line and reduce the floor area, thus contributing to effective three-dimensional utilization of factory space.
- Fine chips can be attracted and oil can be removed efficiently.
- The optimum design by use of high-performance permanent magnets and little attenuation of the magnetic force. Simplified mechanism for trouble-free operation.

[mm(in)]

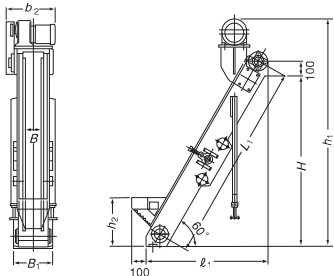

Model	Conveying Speed	Power Source	Motor	Dimensions							Mass	
				B	L	H	B ₁	b ₂	ℓ ₁	h ₁		h ₂
MCO-1515A	Approx. 8/9.5 m/min (50/60Hz)	3-phase 200VAC	400W	150 (5.90)	1500 (59.0)	1270 (50.0)	284 (11.1)	375 (14.7)	925 (36.4)	1620 (63.7)	350 (13.7)	140kg/308 lb
MCO-1520A					2000 (78.7)	1700 (66.9)						1180 (46.4)
MCO-1530A				3000 (118.1)	2570 (101.2)	1675 (65.9)	2905 (114.4)	190kg/418 lb				
MCO-2015A				1500 (59.0)	1270 (50.0)	334 (13.1)	425 (16.7)	925 (36.4)	1620 (63.7)	150kg/330 lb		
MCO-2020A				2000 (78.7)	1700 (66.9)					1180 (46.4)	2060 (81.0)	175kg/385 lb
MCO-2030A				3000 (118.1)	2570 (101.2)	1675 (65.9)	2905 (114.4)	210kg/463 lb				
MCO-2515A				1500 (59.0)	1270 (50.0)	394 (15.5)	475 (18.7)	925 (36.4)	1620 (63.7)	160kg/352 lb		
MCO-2520A				2000 (78.7)	1700 (66.9)					1180 (46.4)	2060 (81.0)	190kg/418 lb
MCO-2530A				3000 (118.1)	2570 (101.2)	1675 (65.9)	2905 (114.4)	230kg/507 lb				

Model MCOL MAGNETIC CHIP CONVEYOR



Powerful type is added to the series. For special sizes, please contact us.

[Application]

This model is installed in front of a tank to which cutting fluid flows from a machine tool to attract (pick up) chips by a magnetic force in cutting fluid to remove and convey them. (This model is suitable for chips shorter than 60 mm.)

[Features]

- A model that plays two roles of horizontal conveyor and inclined conveyor by one unit.
- Can be installed directly on an oil tank or machine tool.

MCOL-2515A

[mm(in)]

Model	Conveying Speed	Power Source	Motor	Dimensions							Mass				
				B	L	H	B ₁	b ₂	ℓ ₁	h ₁		h ₂			
MCOL-1510A	Approx. 8/9.5 m/min (50/60Hz)	3-phase 200 VAC	400W	150 (5.90)	1000 (39.7)	1000 (39.7)	284 (11.1)	375 (14.7)	1600 (62.9)	1390 (54.7)	275 (10.8)	160kg/352 lb			
MCOL-1515A					1500 (59.0)							2100 (82.6)	190kg/418 lb		
MCOL-2010A				200 (7.87)	1000 (39.7)	334 (13.1)	425 (16.7)	1600 (62.9)	220kg/485 lb						
MCOL-2015A				1500 (59.0)	2100 (82.6)	175kg/385 lb									
MCOL-2510A				260 (10.2)	1000 (39.7)	394 (15.5)	475 (18.7)	1600 (62.9)	200kg/440 lb						
MCOL-2515A				1500 (59.0)	2100 (82.6)	250kg/551 lb									
MCOL-H2010A				Approx. 10/12 m/min (50/60Hz)			200 (7.87)	1000 (39.7)	1050 (41.3)	348 (13.7)	473 (18.6)	1664 (65.5)	1565 (61.6)	283 (11.1)	180kg/396 lb
MCOL-H2015A							1500 (59.0)	2164 (85.1)	225kg/496 lb						

