

Model **KPM** PLATE MAGNET

No ON/OFF function



KPMF-1540A

No ON/OFF function



KPMT-1530

[Application]

These magnets are installed on chutes and hoppers to attract and separate magnetic substances such as iron powder from raw materials in chemical, drug and other fine particle industries.

[Features]

- Strong attractive force. Compact and robust.
- Easy installation in any place as no power source is required.
- ※ Magnets with a grip and hinge are available optionally upon request.

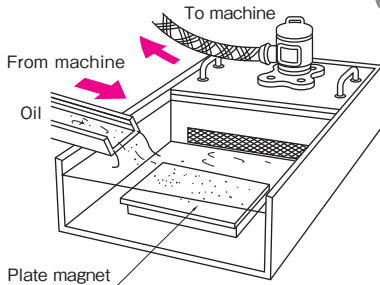

Separated fine iron particles stopped against the flow of materials.

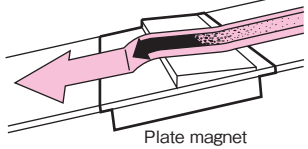

Precautions for use
To use these magnets in liquids (e.g. water) other than oil, please specify "enclosed type."

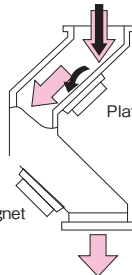

An example of iron-removing magnet fine particle chute line

Model KPMF

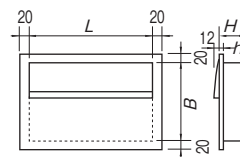

- The whole surface is made of stainless steel (SUS304).
- Large attractive force over a long distance.
- The flange area can be worked on.
- ※ A type having a flange in a different position is also available.

Model KPMT

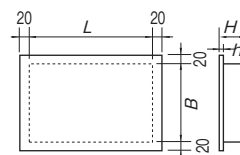

- An iron magnetic plate mounted on the attractive face of Model KPMF.
- The holding power is applied to the attracted iron pieces by the magnetic plate so that they will not be pushed forward by materials that follow.

Standard models

Flat type

[mm (in)]

Model	Dimensions				Attraction Capacity (Distance)			Mass
	B	L	H	h	15-cm nail	M10 nut	M10×25 bolt	
KPMF-1515A		150 (5.90)						6kg/ 13.2 lb
KPMF-1530A		300 (11.8)						11kg/ 24.2 lb
KPMF-1535A		350 (13.7)						13kg/ 28.6 lb
KPMF-1540A	150 (5.90)	400 (15.7)	42.2 (1.66)	3.2 (0.12)	80-100 (3.15-3.93)	40- 60 (1.57-2.36)	60- 80 (2.36-3.15)	15kg/ 33.0 lb
KPMF-1545A		450 (17.7)						17kg/ 37.4 lb
KPMF-1550A		500 (19.6)						18kg/ 39.6 lb
KPMF-1560A		600 (23.6)						22kg/ 48.5 lb
KPMF-2020A		200 (7.87)						13kg/ 28.6 lb
KPMF-2030A		300 (11.8)						20kg/ 44.0 lb
KPMF-2040A	200 (7.87)	400 (15.7)	55.5 (2.18)	3.5 (0.13)	100-130 (3.93-5.11)	60- 80 (2.36-3.15)	80-100 (3.15-3.93)	27kg/ 59.5 lb
KPMF-2050A		500 (19.6)						33kg/ 72.7 lb
KPMF-2060A		600 (23.6)						40kg/ 88.1 lb
KPMF-2080A		800 (31.5)						54kg/ 119.0 lb
KPMF-3030A	300 (11.8)	300 (11.8)	120-160 (4.72-6.29)	70-100 (2.75-3.93)	100-120 (3.93-4.72)	29kg/ 63.9 lb		
KPMF-3040A		400 (15.7)				39kg/ 85.9 lb		
KPMF-3050A		500 (19.6)				49kg/ 108.0 lb		
KPMF-3060A		600 (23.6)				59kg/ 130.1 lb		
KPMF-3080A		800 (31.5)				79kg/ 174.2 lb		

※ Surface magnetic flux density 130 mT (1300 G) max.

With magnetic plate

[mm (in)]

Model	Dimensions				Attraction Capacity (Distance)			Mass
	B	L	H	h	15-cm nail	M10 nut	M10×25 bolt	
KPMT-1515		150 (5.90)						7kg/ 15.0 lb
KPMT-1530		300 (11.8)						12kg/ 26.4 lb
KPMT-1540	150 (5.90)	400 (15.7)	43.5 (1.71)	3.2 (0.12)	80-100 (3.15-3.93)	40- 60 (1.57-2.36)	60- 80 (2.36-3.15)	16kg/ 35.2 lb
KPMT-1550		500 (19.6)						20kg/ 44.0 lb
KPMT-1560		600 (23.6)						24kg/ 52.9 lb
KPMT-2020		200 (7.87)						14kg/ 30.8 lb
KPMT-2030	200 (7.87)	300 (11.8)	56.5 (2.22)	3.5 (0.13)	100-130 (3.93-5.11)	60- 80 (2.36-3.15)	80-100 (3.15-3.93)	21kg/ 46.3 lb
KPMT-2040		400 (15.7)						29kg/ 63.9 lb
KPMT-2050		500 (19.6)						35kg/ 77.1 lb
KPMT-2060		600 (23.6)						42kg/ 92.5 lb
KPMT-3030	300 (11.8)	300 (11.8)	120-160 (4.72-6.29)	70-100 (2.75-3.93)	100-120 (3.93-4.72)	32kg/ 70.5 lb		
KPMT-3040		400 (15.7)				42kg/ 92.5 lb		
KPMT-3050		500 (19.6)				53kg/ 116.8 lb		
KPMT-3060		600 (23.6)				63kg/ 138.9 lb		
KPMT-3080		800 (31.5)						84kg/ 185.2 lb

※ Surface magnetic flux density 250 mT (2500 G) max.

Powerful models Powerful plate magnets using rare earth magnet

Flat type

[mm (in)]

Model	Dimensions				Attraction Capacity (Distance)			Mass
	B	L	H	h	15-cm nail	M10 nut	M10×25 bolt	
KPMF-H1510		100 (3.93)						3.0kg/6.61 lb
KPMF-H1515	150 (5.90)	150 (5.90)	25 (0.98)	3.2 (0.12)	100-130 (3.93-5.11)	60- 80 (2.36-3.15)	80-100 (3.15-3.93)	4.5kg/9.92 lb
KPMF-H1520		200 (7.87)						5.5kg/12.1 lb
KPMF-H1530		300 (11.8)						8.5kg/18.0 lb
KPMF-H2020	200 (7.87)	200 (7.87)	120-160 (4.72-6.29)	70-100 (2.75-3.93)	100-120 (3.93-4.72)	8.0kg/17.6 lb		
KPMF-H2025		250 (9.84)				10.0kg/22.0 lb		
KPMF-H2030		300 (11.8)				11.5kg/25.0 lb		
KPMF-H2040		400 (15.7)				15.5kg/34.1 lb		

※ Surface magnetic flux density 300 mT (3000 G) max.

With magnetic plate

[mm (in)]

Model	Dimensions				Attraction Capacity (Distance)			Mass
	B	L	H	h	15-cm nail	M10 nut	M10×25 bolt	
KPMT-H1510		100 (3.93)						4.0kg/8.80 lb
KPMT-H1515	150 (5.90)	150 (5.90)	25 (0.98)	3.2 (0.12)	100-130 (3.93-5.11)	60- 80 (2.36-3.15)	80-100 (3.15-3.93)	6.0kg/13.2 lb
KPMT-H1520		200 (7.87)						8.0kg/17.6 lb
KPMT-H1530		300 (11.8)						12.0kg/26.4 lb
KPMT-H2020	200 (7.87)	200 (7.87)	120-160 (4.72-6.29)	70-100 (2.75-3.93)	100-120 (3.93-4.72)	8.0kg/17.6 lb		
KPMT-H2025		250 (9.84)				12.5kg/27.5 lb		
KPMT-H2030		300 (11.8)				15.0kg/33.0 lb		
KPMT-H2040		400 (15.7)				20.0kg/44.0 lb		

※ Surface magnetic flux density 500 mT (5000 G) max.

MAGNETIC TOOLS & EQUIPMENT FOR MINING OPERATION
LIFTING MAGNET
MAGBORG
MAGNETIZER AND ENVIRONMENTAL EQUIPMENT
MAGNETIZER AND DEMAGNETIZER
MAGNETIC EQUIPMENT FOR CONVEYANCE
MAGNETIC SEPARATORS
MEASURING TOOLS
MAGNETIC MATERIALS