

# MAGNETIC TOOLS

**A cleaning device to collect nails, needles, iron pieces, etc. scattered around on the floor and road.**

## Model RS ROAD SWEEPER

### [Application]

This is suitable for collection of such iron pieces as nails, needles and chips scattered around on floors in machining places, warehouses and event sites or on road. In addition, this device works well for collection of dust mixed with fine iron powder. This device protects people and tires of vehicles and is also useful for recycling purposes.

### [Features]

- The attractive part extends up to the end to enable attraction in deep corners.
- The simple construction by use of plate magnet type to facilitate maintenance such as changing wheels and covers.
- Self-standing and small storage space.
- Easy operation; pull the hand lever to release attracted pieces.

Model	Capacity	Dimensions		Wheel Dia.	Height (Self-standing)	Mass
		Width	Attractive part width			
RS-P0930	1kg/2.20 lb (ø1 shot blast balls)	466 (18.3)	308 (12.1)	φ 100 (3.93)	1090 (42.9)	7kg/15.4lb

Attracting chips



Releasing chips



An example of dust collection

An example of special fabrication of RS (Road Sweeper)

## Model S MAGNETIC SWEEPER

This sweeper employs a powerful permanent magnet and is capable of collecting iron pieces even in mud. This sweeper collects harmful iron pieces such as needles and nails to protect people and tires of vehicles and is also useful for recycling purposes.

### [Application]

Suitable for collecting iron pieces on floors in sewing factories, machine shops and woodworking mills.

Useful for cleaning warehouses and truck terminals.

Useful for preparatory work of race tracks and stadiums.

Suitable for cleaning floors after constructing and demounting displays in exhibition events.

### [Features]

- Powerful permanent magnet.
- Easy operation; pull the hand lever to release attracted pieces.
- Self-standing and small storage space.

Model	Capacity	Dimensions		Height	Mass
		Width	Attractive part width		
S-05A	3cm (1.18) nails approx. 0.3 kg/0.66 lb	254 (9.99)	145 (5.70)	919 (36.1)	3.8kg/8.39 lb
S-1D	3cm (1.18) nails approx. 0.45kg/0.99 lb	461 (18.1)	362 (14.2)	1050 (41.3)	4.5kg/9.92 lb



RS-P0930

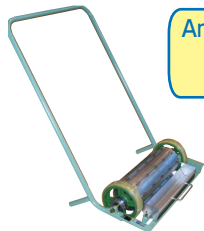

ON/OFF function provided

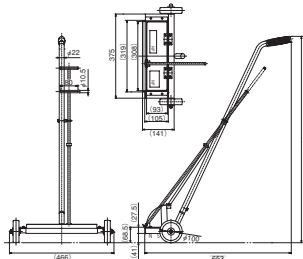

S-05A

ON/OFF function provided



S-1D

## Model K MAGNETIC HOLE CLEANER



K-2025A

K-1015A

K-510A

K-5F

K-N

[mm (in.)]

Model	Capacity		Dimensions	Length	Mass
	M3×6	M3 plain washer			
K-510A	φ 5 (0.19) side	4g/0.008 lb	3g/0.006 lb	φ 5 (0.19) × 30 (1.18)	250 (9.84)
	φ 10 (0.39) side				
K-1015A	φ 10 (0.39) side	7g/0.0015 lb	4g/0.008 lb	φ 10 (0.39) × 18 (0.70)	45g/0.098 lb
	φ 15 (0.59) side				
K-2025A	φ 20 (0.78) side	21g/0.046 lb	19g/0.041 lb	φ 20 (0.78) × 18 (0.70)	257 (10.1)
	φ 25 (0.98) side				
K-5F	4g/0.008 lb	3g/0.006 lb	φ 5 (0.19) × 30 (1.18)	232 (9.13)	26g/0.573 lb
K-10F					
K-15F	7g/0.015 lb	4g/0.008 lb	φ 15 (0.59) × 15 (0.59)	217 (8.54)	35g/0.077 lb
			φ 15 (0.59) × 15 (0.59)		46g/0.101 lb

### [Application]

Useful for removing iron chips after drilling and tapping and removing iron pieces from holes.

### [Features]

- This cleaner, small diameter having a separator incorporated, is constructed to have the magnetic poles concentrated on the same attractive face.

An example of usage of K-5F

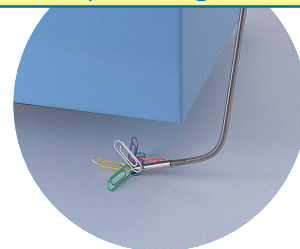

K-5F/10F/15F have a flexible rod.

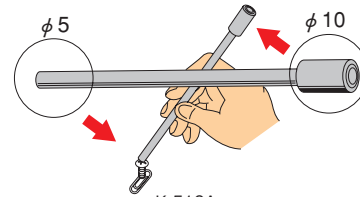

K-510A

Model	Holding Power	Dimensions		Mass
		[mm (in.)]		
K-N	10N (1kgf)	φ 8 (0.31) × 145 (5.70)	26g/0.057 lb	
		(6-step full length 635 (24.9))		

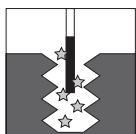

Attracting & removing chips

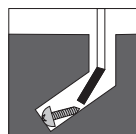

Collecting fallen parts

