

Model RTH SUPER THIN RECTANGULAR PERMANENT MAGNETIC CHUCK

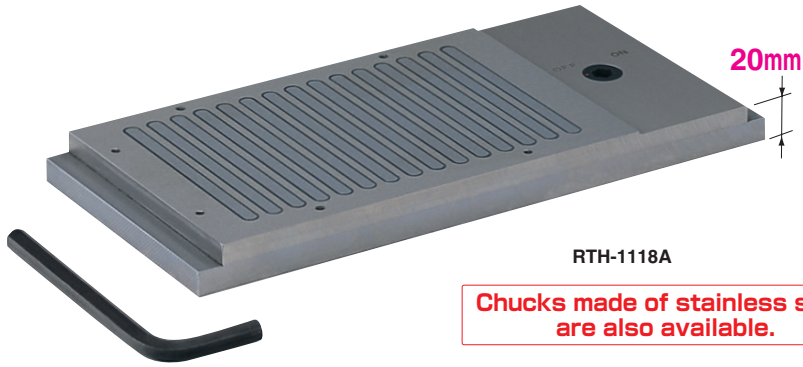

RTH-1118A

Chucks made of stainless steel are also available.

[Application]

Suitable for securing workpieces for high speed and light duty grinding. (To use these chucks in liquid or in wet conditions, use machining fluid of rust-preventive type.) The light weight design makes these chucks suitable for setup change (pallet change) operations by workers also.

[Features]

- Very thin (only 20 mm high) and light weight permanent magnetic chucks.

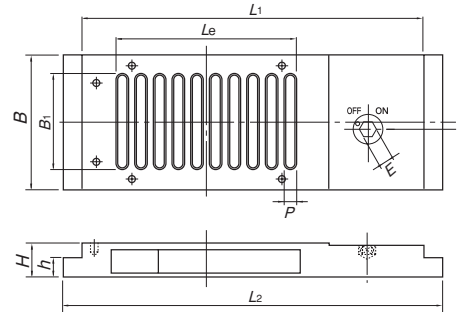

Model	Nominal Size	Work Face				Pole Pitch P	Mounting Face			Height H	Handle Hole E	Mass
		B	L ₁	B ₁	L _e		L ₂	B	h			
RTH-713A	70(2.75) × 130(5.11)	70 (2.75)	180 (7.08)	50 (1.96)	97 (3.81)	10(1+5+1+3) (0.39)	200 (7.87)	70 (2.75)	10 (0.39)	20 (0.78)	8 (0.31)	2 kg/ 4.4 lb
RTH-1118A	110(4.33) × 180(7.08)	110 (4.33)	230 (9.05)	90 (3.54)	147 (5.78)		250 (9.84)	110 (4.33)				3.7kg/ 8.1 lb
RTH-1515A	150(5.90) × 150(5.90)	150 (5.90)	200 (7.87)	130 (5.11)	117 (4.60)		220 (8.66)	150 (5.90)				4.5kg/ 9.9 lb

※As for the handle, a hex wrench key is included.

Model SKM VERTICAL PERMANENT MAGNETIC CHUCK



SKM-1325

An example of mounting

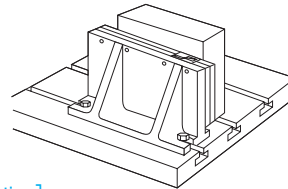

[Application]

These chucks are suitable for applications where when securing a workpiece on the table of a machine, it needs to be held vertically due to its shape or it needs to be secured from sides additionally when it cannot be held sufficiently horizontally.

[Features]

- The permanent magnetic chuck used in Model SKM is our powerful RMT.
- Hold various sizes of workpieces; thin, small and thick.

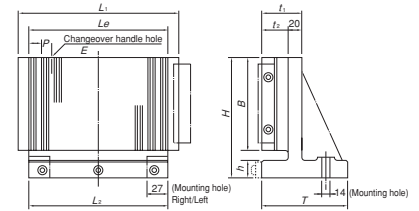

Model	Nominal Size	Work Face			Pole Pitch P	Mounting Face		Thickness		Height		Handle Hole E	Mass	
		B	L ₁	L _e		T	L ₂	t ₁	t ₂	H	h			
SKM-1018	100(3.93) × 175(6.89)	100(3.93)	175(6.89)	137(5.39)	14.5(1.5+3.2+1.5+8.3) 0.57 (0.05+0.12+0.05+0.32)	130 (5.11)	145(5.70)	70 (2.75)	50 (1.96)	130(5.11)	20 (0.78)	Hex. 8 (0.31)	13kg/28 lb	
SKM-1325	125(4.92) × 250(9.84)	125(4.92)	250(9.84)	209(8.22)			210(8.26)	220(8.66)	260(10.2)	160(6.29)			180(7.08)	22kg/48 lb
SKM-1530	150(5.90) × 300(11.8)	150(5.90)	300(11.8)	253(9.96)			260(10.2)	260(10.2)	260(10.2)	180(7.08)			180(7.08)	30kg/66 lb

※One set of stoppers is included. As for the handle, a hex wrench key is included.

Model SKAW VERTICAL PERMANENT MAGNETIC CHUCK

A new powerful model added to permanent magnetic chucks forsecuring workpieces in vertical direction!

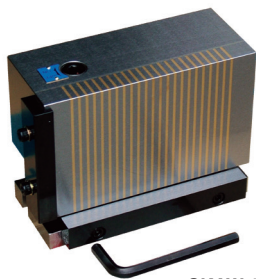

SKAW-1018

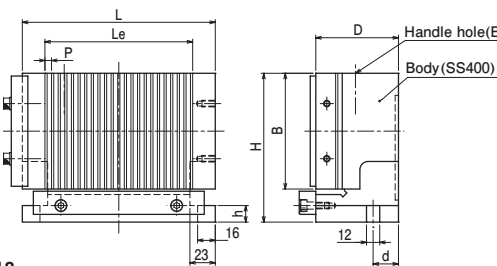

[Application]

This chuck is suitable for applications where when securing a workpiece on the table of a machine, it needs to be held vertically due to its shape or it needs to be secured from sides additionally when it cannot be held sufficiently horizontally.

[Features]

- Compared with Model SKM, this model can hold smaller and thinner (3 mm) workpieces.
- The rigid construction facilitates maintenance such as recovering the original accuracy.

The standard material of the angle plate is SS400, but it may be made of SKD-11 (HRC60).

Model	Nominal Size	Work Face			Pole Pitch P	Thickness D	Height H	Mounting Face		Handle Hole E	Mass
		B	L	L _e				d	h		
SKAW-1018	105(4.13) × 175(6.89)	105(4.13)	175(6.89)	134(5.27)	75(2.95)	135(5.31)	23(0.90)	12(0.47)	Hex. 8(0.31)	14kg/30 lb	

※One set of stoppers is included. As for the handle, a hex wrench key is included.

ELECTROMAGNETIC CHUCKS
CHUCK CONTROLLERS
PERMANENT MAGNETIC CHUCKS
PERMANENT ELECTROMAGNETIC CHUCKS
BLOCKS FOR MC
VACUUM CHUCKS
PROMELTA* SYSTEM
SINE BAR CHUCKS
BLOCKS HOLDERS, MINI CHUCKS
HOLDING TOOLS
MEASURING TOOL HOLDERS
MAGNETIC HOLDERS
MAGNETIC TOOLS